

## 9" DIAMETER VARIABLE DISCHARGE BLOWER

### Fan Dimensions:

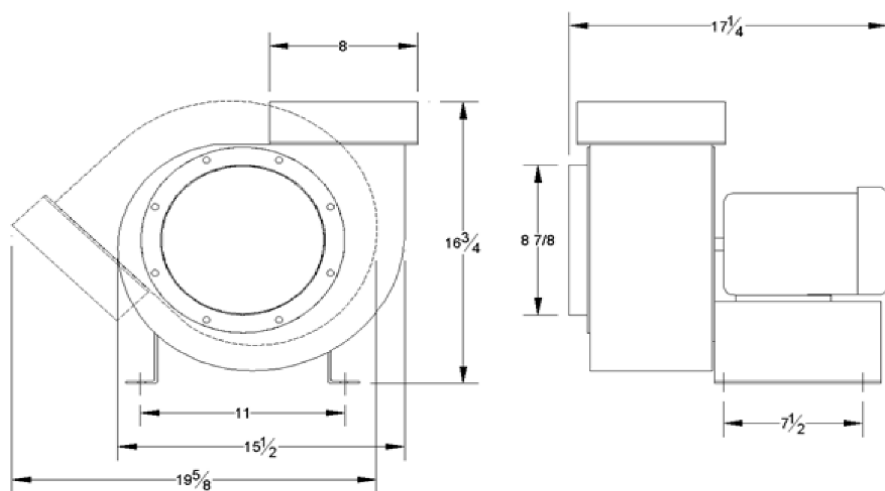

### Fan Ratings:

Model #	VEB09M115A
HP	1
Hertz	60
RPM	1755
Volts	115*
Phase	1
CFM @ 0" W.G.	2,030
CFM @ 1/2" W.G.	1,880
CFM @ 1" W.G.	1,680
WT.-LBS.	85

### Electrical Data:

	Volts	115*
AMP	Nameplate	12.4
	Locked Rotor	39.0
	Power Factor	77

\* will operate on 115/208-230 V

**Housing:** Scroll, 12 GA. Motor mount/base 10 GA. Hot dip galvanized for durability. Round flanges on intake and exhaust for mounting ductwork. Discharge can be rotated in  $22\frac{1}{2}^\circ$  increments

**Motor:** Open drip proof motor, heavy duty, greasable bearings, Heavy gauge steel frame, Gasketed conduit box

**Impeller:** Heavy duty all steel construction. Forward curved, 9" diameter, 4.5" wide, Browning hub.



NOTE: Electrical and noise data are supplied by the motor and propeller manufacturers, respectively. These values have not been independently verified by California Turbo, Inc. California Turbo, Inc. reserves the right to make product changes from time to time, without prior notification.

Call Sharpe Heating and Ventilating today for details and product offerings

Phone: (562) 695-5221 / Email: [sharpe@dmghvac.com](mailto:sharpe@dmghvac.com)